

LUXIONA



Lighting Solutions
INDUSTRY

LIGHTING CONTROL SYSTEMS IN INDUSTRIAL OBJECTS

Lighting control systems increase usability and functionality of LED lighting but first of all they allow achieving significant energy savings in a **range of 60-90 %**.

Selection of controlling systems is carried out on stage of concept creation and designing lighting solutions in both new and modernized objects. All of LUXIONA Poland luminaries are equipped with components allowing to create desired application of controlling systems. They are a great base to build control systems of freeform functionality.

Control systems allow:

- managing the lighting divided into single aisles between racks,
- maintaining permanent illuminance, taking into account daylight influence,
- programming annual algorithms of lighting utilisation (light scenes),
- controlling and supervising over technical parametres of lighting devices operation.

SPIS TREŚCI

Universal Line LED	04
Atena Line New LED	08
Atena LED	10
Agaline LED 3R	12
Prison LED	14
Neptun LED V1	16
Rubin Industry Slight LED	18
Streetpark S LED / M LED	20
Tube LED	22

UNIVERSAL LINE LED



- Modern design
 - System created on aluminum profile base
 - Simple, quick and toolless assembly of lighting line
 - Possibility of applying the single luminaire version
 - Available IP levels: IP65 (indoor solutions) oraz IP55 (outdoor solutions)
 - Surface mounting or on slings
 - Available accessories: ceiling clips, clips for slings, slings
-
- Lifetime of LED sources: 100000 h L80/B10, 147000 h L70/B50
 - SDCM = 3
 - Operating temperature range: -25 ÷ +30° C
 - Type of optics: PLX (opalised diffuser PMMA), PLX-T (transparent diffuser PMMA), Micro-PRM (micro prismatic diffuser PC), lenses
 - Power supply: electronic (standard) or DIM DALI (optional)

Name	Version*	Module	Lenght	Luminaire power [W]	LED flux [lm]	Color of light [K]	CRI
UNIVERSAL LINE 4400	LED	SOL, LINE-EL, LINE-S, LINE-EP	L-1159	28	4410 / 4644	3000 / 4000	>80
UNIVERSAL LINE 8800	LED	SOL, LINE-EL, LINE-S, LINE-EP	L-2288	56	8820 / 9288	3000 / 4000	>80
UNIVERSAL LINE 8000	LED	SOL, LINE-EL, LINE-S, LINE-EP	L-1159	53	8052 / 8330	3000 / 4000	>80
UNIVERSAL LINE 16000	LED	SOL, LINE-EL, LINE-S, LINE-EP	L-2288	106	16104 / 16660	3000 / 4000	>80

* note: also available version:
AL - empty aluminium profile

Standard color: anodised aluminium

Dimensions:

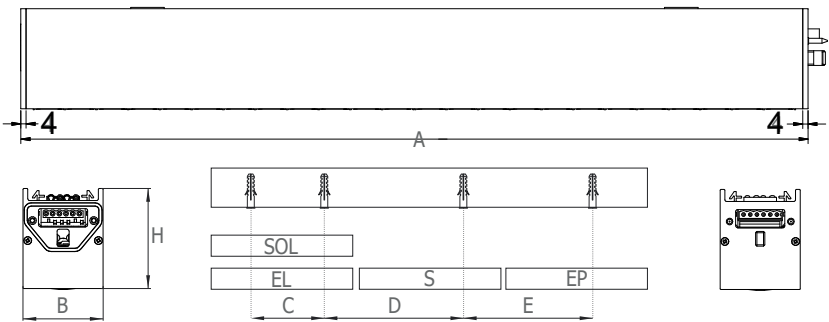

TYPE	A (mm)	B (mm)	H (mm)	C (mm)	D (mm)	E (mm)
L-1159	1159	60	75	930	1162	1162
L-2288	2288	60	75	1990	2306	2306

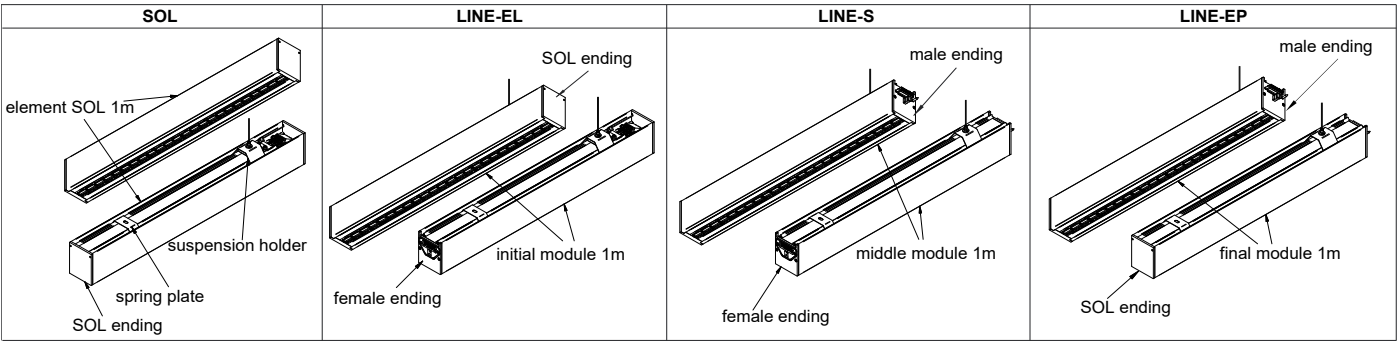

Accessories:



Types of linear modules:



Initial module LINE-EL with the flat ending on the one side and female ending on the other. Module is suitable to connect the power.



Middle module LINE-S with male ending on the one side and female ending on the other.



Final module LINE-EP with male ending on the one side and flat ending on the other.



IP55 / IP65 - Power connection.

Type of optics:

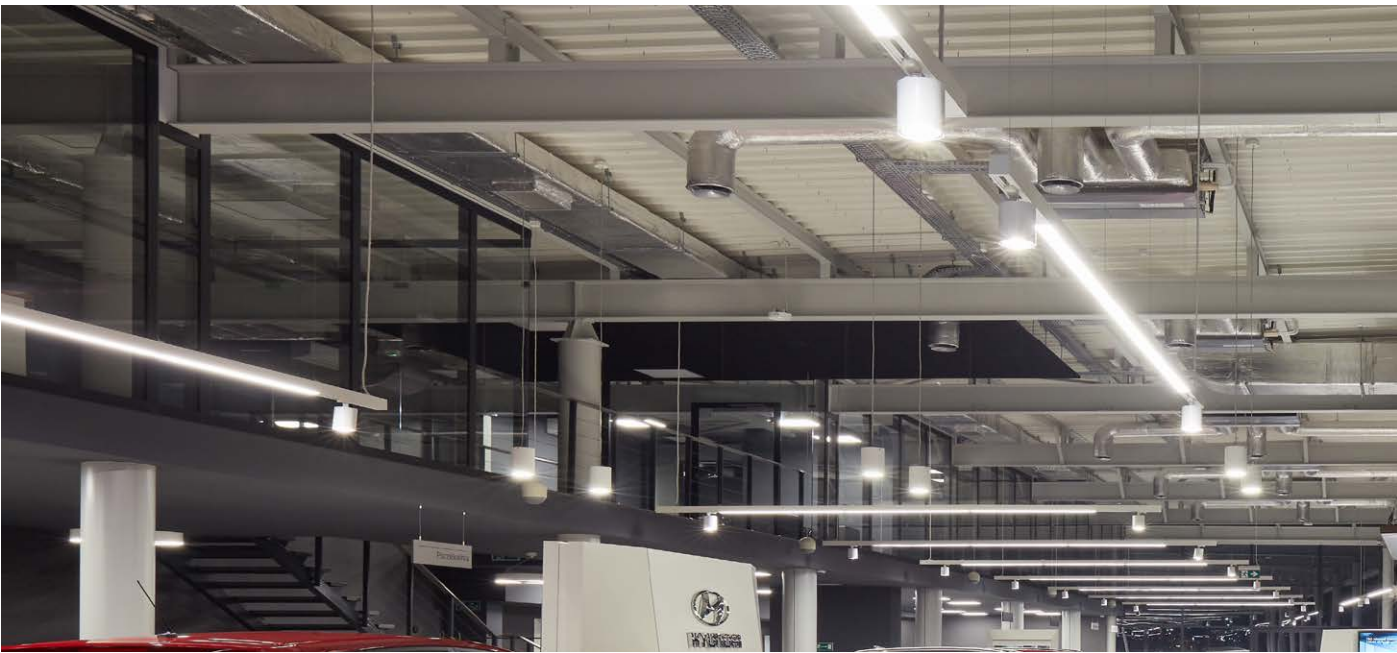

ATENA LINE NEW LED



- Version 'New' is designed in a new more effective housing
 - Made of specially designed aluminium profile
 - Standardly the luminaire is available in four different versions in terms of luminous flux value
 - Surface mounted luminaire with possibility to change type of mounting upon request
 - Possibility to produce in a way which ensures connection of two luminaires
 - Standard version is equipped with a 1 metre long wire outside the housing
-
- Lifetime of LED sources: 83000 h L90/B10
 - SDCM = 2
 - Operating temperature range: -25 ÷ +40° C
 - Type of diffuser: SH (hardened glass)
 - Available light distributions: narrow, medium, wide, WIDE ODB
 - Power supply: electronic (standard) or DIM DALI (optional)

Name	Luminaire power [W]	LED flux [lm]	Color of light [K]	CRI
ATENA LINE NEW LED 18000	125	17160 / 18555	4000 / 5000	80 / 70
ATENA LINE NEW LED 24000	166	22880 / 24740	4000 / 5000	80 / 70
ATENA LINE NEW LED 30000	208	28600 / 30925	4000 / 5000	80 / 70
ATENA LINE NEW LED 36000	249	34320 / 37110	4000 / 5000	80 / 70

Standard color: RAL9005 (black)

Dimensions:

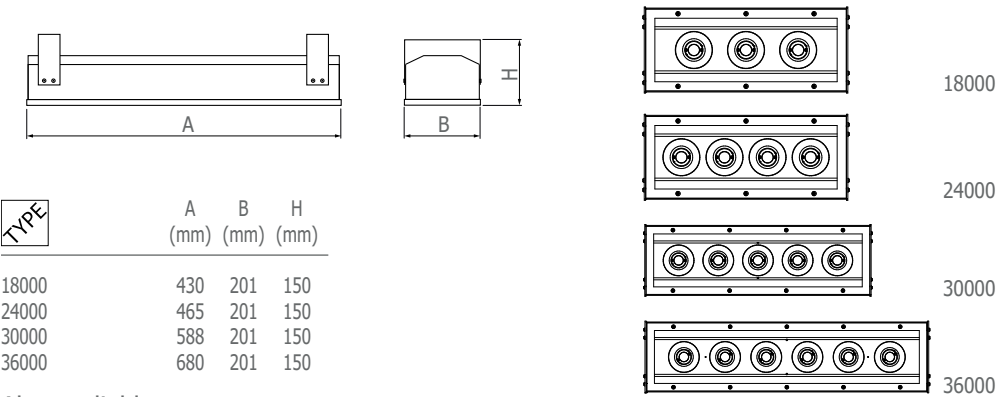

Also available:



ATENA LINE NEW LED INDUSTRY
The luminaire is suitable to operate in temperature from -25°C to +50°C

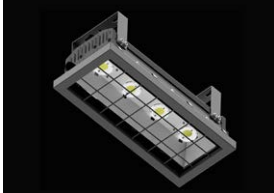

ATENA LINE NEW LED GRID
Luminaire with a protective grid



ATENA LINE NEW LED ROTARY HOLDER
Fixing on the holder which allows to regulate the angle of gradient



Possibility of connection two fittings in one segment - a ceiling holder



Possibility of connection two fittings in one segment - a rotary holder



Possibility of 1-point assembly on a rigid rod (rod should be provided by client)



ATENA LED



- Body is made from aluminum cast which at the same time plays role of a radiator for LED modules placed inside
 - High level of protection against penetration of dust and water - IP65
 - Available versions: STANDARD, NARROW, INDUSTRY, POLAR
-
- Lifetime of LED sources: 83000h przy L90/B10
 - SDCM = 2
 - Operating temperature range:
 - 25 ÷ +40° C (Standard version)
 - 25 ÷ +45° C (Industry version)
 - 40 ÷ +40° C (Polar version)
 - Type of diffuser: SH (tempered glass), Micro-PRM SH (micro-prismatic diffuser with tempered glass)
 - Power supply: electronic (standard) or DIM DALI (optional)

Name	Luminaire power [W]	LED flux [lm]	Color of light [K]	CRI
ATENA LED 10000	83	11440 / 12370	4000 / 5000	>80 / >70
ATENA LED 15000	125	17160 / 18555	4000 / 5000	>80 / >70
ATENA LED 20000	166	22880 / 24740	4000 / 5000	>80 / >70
ATENA LED 25000	208	28600 / 30925	4000 / 5000	>80 / >70
ATENA LED 30000	249	34320 / 37110	4000 / 5000	>80 / >70

Standard color: gray

Dimensions:

TYPE	D (mm)	H (mm)
STANDARD	457	288
NARROW	422	253

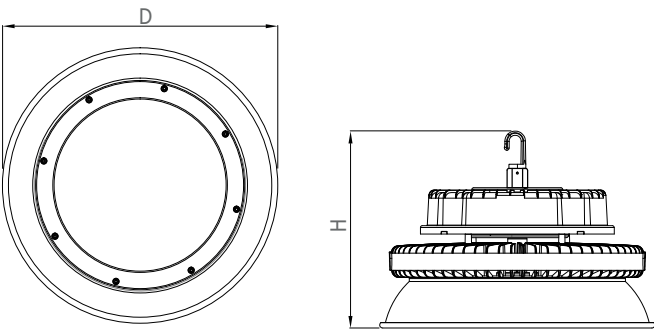

The luminaire is also available as a floodlight Sparta LED:



AGALINE LED 3R



- Luminaire made of steel sheet
 - Optical system based on lenses, assuring different light distributions
 - Four possible versions in terms of the value of luminous flux
 - Color of light 4000 K or 5000 K
 - High level of protection against penetration of dust and water - IP65
 - Mounting on slings
-
- Lifetime of LED sources: 54000 h L80/B10
 - SDCM = 3
 - Operating temperature range: 5 ÷ 30° C
 - Type of optics: lenses
 - Power supply: electronic (standard) or DIM DALI (optional)

Name	Luminaire power [W]	LED flux [lm]	Color of light [K]	CRI
AGALINE LED 3R 10800	78	10620 / 10785	4000 / 5000	>80
AGALINE LED 3R 14400	104	14160 / 14380	4000 / 5000	>80
AGALINE LED 3R 18000	131	17700 / 17975	4000 / 5000	>80
AGALINE LED 3R 21600	157	21240 / 21570	4000 / 5000	>80

Standard color: ☐ RAL9016 (white)

Dimensions:

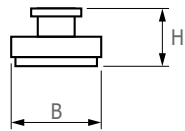
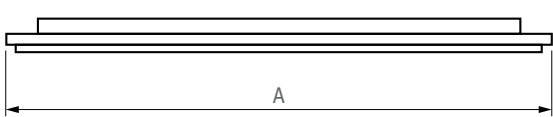

Type	A (mm)	B (mm)	H (mm)
10800	940	95	68
14400	1250	95	68
18000	1550	95	68
21600	1860	95	68



PRISON LED



- Luminaire made of steel sheet
 - Robust design resistant to impacts of 40 J force
 - Frame mounted with vandal-proof screws
 - High level of protection against penetration of dust and water - IP65
 - The luminaire dedicated for rooms, where it can be exposed to acts of vandalism and excessive moisture
-
- Lifetime of LED sources: 100000 h L80/B10, 147000 h L70/B50
 - SDCM = 3
 - Operating temperature range: -25 ÷ +30° C
 - Type of optics: PC opal diffuser
 - Power supply: electronic (standard) or DIM DALI (optional)

Name	Luminaire power [W]	LED flux [lm]	Color of light [K]	CRI
PRISON LED 2600	17	2840	4000	>80
PRISON LED 4400	28	4644	4000	>80
PRISON LED 5200	34	5680	4000	>80
PRISON LED 8800	56	9288	4000	>80
PRISON LED 10400	68	11360	4000	>80
PRISON LED 13200	83	13932	4000	>80

Standard color: ☐ RAL9016 (white)

Dimensions:

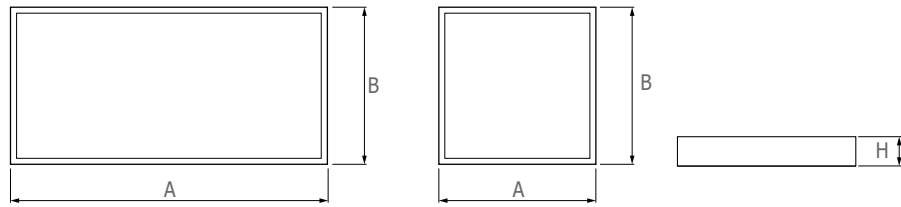

TYPE	A (mm)	B (mm)	H (mm)
2600	400	400	60
4400	400	400	60
2600	650	325	50
4400	650	325	50
5200	650	650	50
8800	650	650	50
5200	1240	200	50
8800	1240	200	50
10400	1240	200	50
13200	1240	200	50



NEPTUN LED V1



- Tightly-closed surface mounted luminaire
 - Housing and diffuser made of polycarbonate
 - Possibility of looping through power supply
 - Resistance to chemical substances (GRP version)
 - Optical system based on lenses ensuring various light distributions (Optics version)
 - Adapted to high temperatures: up to +50° C for Industry version
 - Available accessories: slings
-
- Lifetime of LED sources: 100000 h L80/B10, 147000 h L70/B50
 - SDCM = 3
 - LEDs photobiological safety class: RG0
 - Operating temperature range: -25 ÷ +30° C
 - Type of optics: PC OPAL (PC opalised diffuser), PC-T (clear PC diffuser) with lenticular optical system
 - Power supply: electronic (standard) or DIM DALI (optional)

Name	Luminaire power [W]	LED flux [lm]	Color of light [K]	CRI
NEPTUN LED V1 2600	17	2698 / 2840	3000 / 4000	>80
NEPTUN LED V1 4400	28	4410 / 4644	3000 / 4000	>80
NEPTUN LED V1 5200	39	5734 / 5814	3000 / 4000	>80
NEPTUN LED V1 5500	35	5515 / 5805	3000 / 4000	>80
NEPTUN LED V1 8800	56	8820 / 9288	3000 / 4000	>80
NEPTUN LED V1 10000	68	10278 / 10829	3000 / 4000	>80
NEPTUN LED V1 11000	70 / 76	10982 / 11030	3000 / 4000	>80

Standard color: gray

Dimesions:

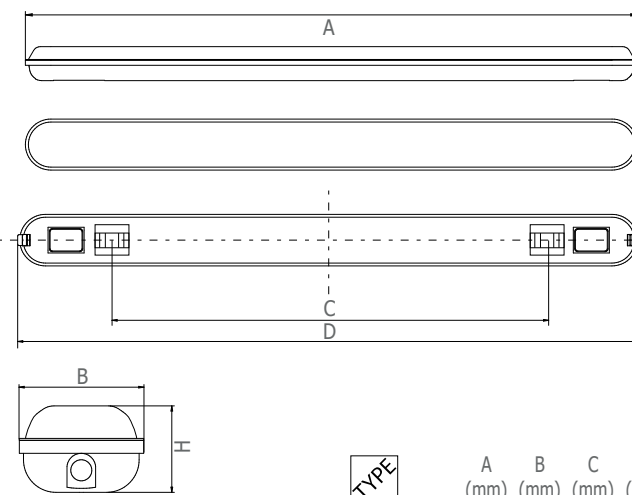

TYPE	A (mm)	B (mm)	C (mm)	D (mm)	H (mm)
2600	1200	100	820	1208	68
4400	1200	100	820	1208	68
5200	1200	100	820	1208	68
8800	1200	100	820	1208	68
10000	1200	100	820	1208	68
5500	1500	100	1120	1508	68
11000	1500	100	1120	1508	68

Luminaire available also in verions:



Industry version

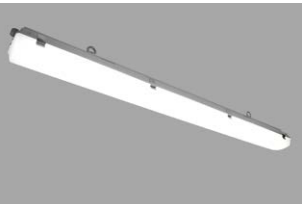

GRP version



Optics version

Accessories:

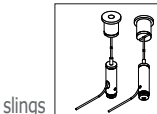

slings



RUBIN INDUSTRY SLIGHT LED



- Surface mounted luminaire
 - Luminaire made of steel sheet
 - The height of the luminaire is only 55 mm
 - Equipped with highly efficient LED light sources
 - Light distribution realised by means of highly efficient lenses
-
- Lifetime of LED sources: 100000 h L80/B10, 147000 h L70/B50
 - SDCM = 3
 - Operating temperature range: -25 ÷ +45° C (for 32000 max: +40° C)
 - Type of optics: SH (tempered glass), PC-T (PC transparent diffuser)
 - Power supply: electronic (standard)

Name	Luminaire power [W]	LED flux [lm]	Color of light [K]	CRI
RUBIN INDUSTRY SLIGHT LED 16000	114	16104 / 16660	3000 / 4000	>80
RUBIN INDUSTRY SLIGHT LED 24000	171	24156 / 24990	3000 / 4000	>80
RUBIN INDUSTRY SLIGHT LED 32000	228	32208 / 33320	3000 / 4000	>80

Standard color: ☐ RAL 9016 (white)

Dimensions:

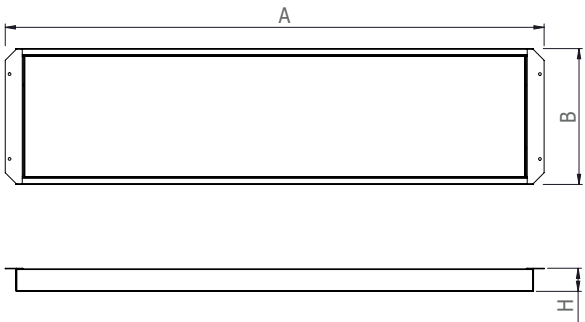

Type	A (mm)	B (mm)	H (mm)
16000	1270	320	55
24000	1270	320	55
32000	1270	320	55



STREETPARK S LED / M LED



- Outdoor luminaire
 - Housing made of powder-coated aluminum cast
 - Seven types of optics dedicated for different places:
(highways and local roads light, parkings, zebra crossing, high surface areas or narrow paths)
 - Toolless clips to open the light housing body without tool
 - Optional: voltage surge protector that does not require interference during the assembly and disassembly of the power supply system
 - The luminaire is equipped with adjustable handle designed for mounting on posts and arms of 60 mm diameter
-
- Lifetime of LED sources: 60000 h L70/B10
 - SDCM = 5
 - Operating temperature range: -40 ÷ +40° C
 - Type of optics: SH (tempered glass) with lenses
 - Power supply: electronic (standard)

Name	Version	Luminaire power [W]	LED flux [lm]	Color of light [K]	CRI
STREETPARK S LED 4000	HE	28	3965	5700	>70
STREETPARK S LED 8000	HE	55	7930	5700	>70
STREETPARK S LED 12000	HE	83	11895	5700	>70
STREETPARK S LED 5500	HO	42	5588	5700	>70
STREETPARK S LED 11000	HO	83	11175	5700	>70
STREETPARK M LED 5000	HE	35	5287	5700	>70
STREETPARK M LED 10000	HE	71	10574	5700	>70
STREETPARK M LED 15000	HE	106	15861	5700	>70
STREETPARK M LED 7500	HO	54	7450	5700	>70
STREETPARK M LED 15000	HO	107	14900	5700	>70
STREETPARK M LED 22000	HO	161	22350	5700	>70

Standard color: RAL9007 (dark grey)

Dimensions:

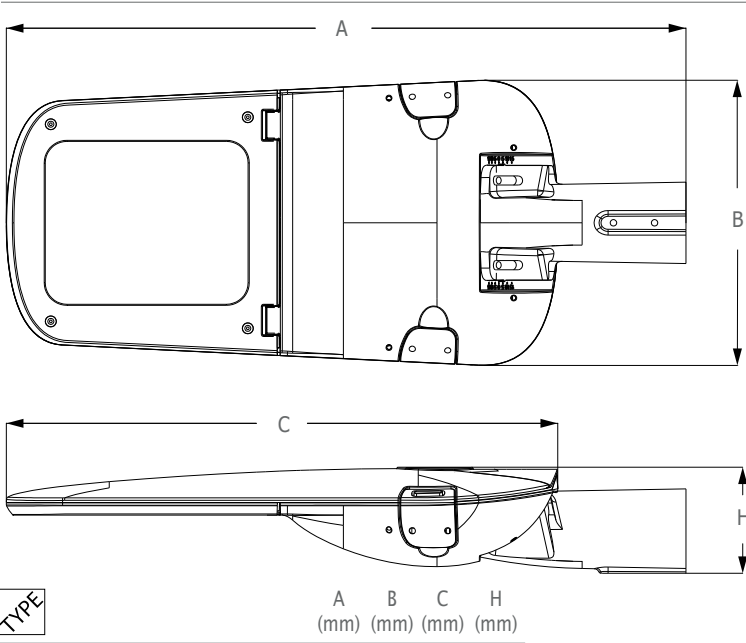

TUBE LED



- Industrial floodlight
 - Equipped with highly efficient and energy saving LED light sources
 - The housing made of aluminum black colour
 - Mounting on the adjustable handle
 - Accessories: handle dedicated for mounting on posts and arms of diameter 60 mm
-
- Lifetime of LED sources: 60000 h L70/B10
 - SDCM = 5
 - Operating temperature range: -40 ÷ +40° C
 - Type of diffuser: SH (hardened glass)
 - Power supply: electronic (standard)

Name	Luminaire power [W]	LED flux [lm]	Color of light [K]	CRI
TUBE LED 7500	54	7450	5700	>70
TUBE LED 15000	107	14900	5700	>70
TUBE LED 20000	147	20200	5700	>70

Standard color: RAL9016 (black)

Dimensions:

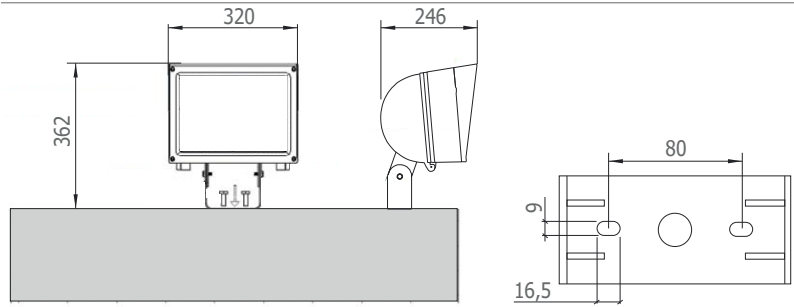

Possibility of cover assembly:

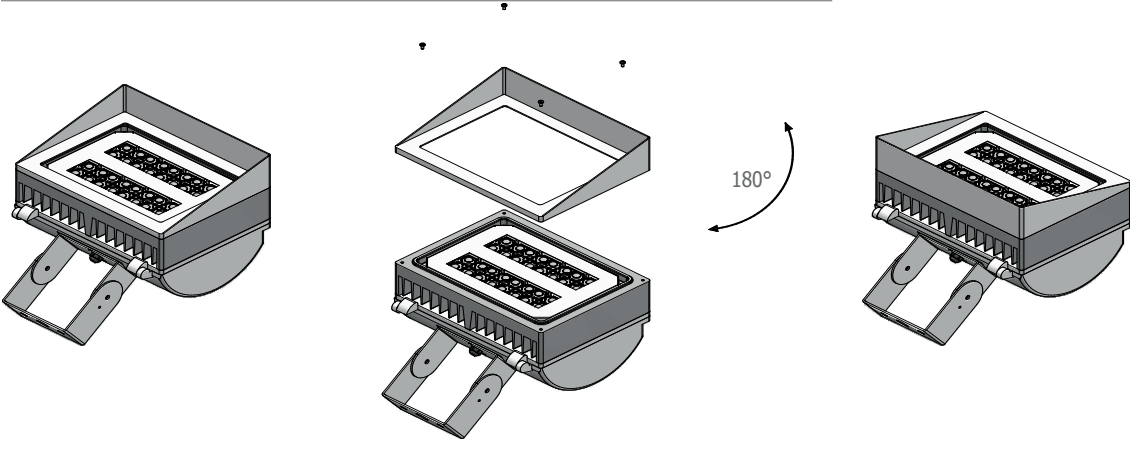

Accessories:



handle dedicated for mounting on posts and arms of 60 mm diameter

www.luxiona.pl/en



LUXIONA



OFFICE OF THE MANAGEMENT BOARD /TRADE OFFICE:

LUXIONA Poland S.A. Macierzysz near Warsaw
ul. Sochaczewska 110,
05-850 Ozarów Mazowiecki
sekretariat@luxiona.com

www.luxiona.pl/en

www.luxiona.com

EXPORT DEPARTMENT:

UK, IR
+48 600 987 439
export@luxiona.com

DE, AT, CH, LI
+49 30 40535600
info@luxiona.de

SE, NO, DK, IS, BE, NL, LU
+ 48 505 695 581
export@luxiona.com

LT, EE, FI, RU, UA, LV, BY, MD, GE,
AM, AZ, KZ, UZ, TM, TJ, KG
+ 370 650 22 522
export@luxiona.com

HR, HU, RO, XS, SI
+48 505 695 568
export@luxiona.com

CZ, SK, BA, ME, MK, XK, AL, BG
+ 48 604 442 101
export@luxiona.com

DESIGN DEPARTMENT:

+ 48 22 721 72 29
+ 48 600 460 144
projektanci@luxiona.com

LUXIONA Poland is part of the Spanish LUXIONA Group, which over 90 years has been successfully operating on the international market of the lighting industry. The mission of LUXIONA Poland is to create complementary lighting solutions, in accordance with the most recent technologies as well as legal and social requirements. For that reason, an active team constantly works on innovative technical solutions, keeping in mind the need for saving energy and protecting the environment. The team does not cease to enhance the quality of our products and the efficiency of our services, permanently analyzing the needs of our Customers.

The LUXIONA Group, including LUXIONA Poland which continues to implement the Group strategy, specializes in the composition and creation of indoor and outdoor lighting systems, basing on the vast experts' experience and the broad scope of product brands. An integral part in the offer of LUXIONA Poland are comprehensive lighting solutions, which cover both the production and design services, in the widest sense of the word, delivered by high class designers and ready to meet the requirements of, among others: architectural spaces, areas in the so-called clean rooms, commercial surfaces etc. The LUXIONA Poland team specializes in implementing projects which require an individual approach and the application of modern technologies.