

LUXIONA

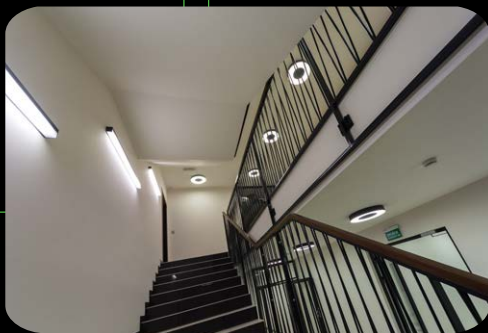

Residential Buildings
&
Outdoor Lighting



TABLE OF CONTENTS

Indoor luminaires:	04
X-Line LED	06
X-Line SQ N LED	08
Rubin Look LED Smooth Compact	10
Essence LED	12
Ring LED	14
Beryl New LED O	16
Beryl N New LED O	18
Lotos Elegance LED PC LED Compact	20
Lotos LED White PC LED Compact	22
Neptun LED V1	24
Outdoor luminaires:	26
Fasad ODL LED	28
Kubik Wall Eco LED	30
Online N LED	32
Mark LED	34
Polar LED	36
Kubik Pole LED	38
Kubik Pole 2D LED	40
Kubik Pole 4D LED	42
Kubik Pole L LED / T LED	44
Filar LED	46
LED Profiles:	50
Lampas LED	50



A modern office hallway with a white ceiling featuring several square recessed LED lights. The walls are a mix of red brick and dark grey panels. On the left, there's a white reception desk with a dark grey countertop. In the background, there are glass doors and a staircase visible through a glass partition on the right.

INDOOR LUMINAIRES

X-LINE LED



- Minimalistic and universal design
 - Aluminum profile
 - The luminaire available in various length options
 - Surface mounting or mounted on slings
 - Available accessories: slings
-
- Lifetime of LED sources: 60000 h L80/B10
 - SDCM = 3
 - Operating temperature range: 5 ÷ 30° C
 - Type of optics: PLX (opalised diffuser PMMA), Micro-PRM (micro prismatic diffuser PMMA)
 - Power supply: electronic (standard) or DIM/DALI (optional)

Name	Lenght	LED flux [lm]	Luminaire power [W]	Color of light [K]	CRI
X-LINE LED 1300 LM	L-600	1349 / 1420	9	3000 / 4000	>80
X-LINE LED 2200 LM	L-600	2205 / 2322	14	3000 / 4000	>80
X-LINE LED 2600 LM	L-1200	2698 / 2840	17	3000 / 4000	>80
X-LINE LED 4400 LM	L-1200	4410 / 4644	28	3000 / 4000	>80
X-LINE LED 3250 LM	L-1500	3370 / 3550	21	3000 / 4000	>80
X-LINE LED 5500 LM	L-1500	5515 / 5805	35	3000 / 4000	>80
X-LINE LED 3900 LM	L-1800	4047 / 4260	26	3000 / 4000	>80
X-LINE LED 6600 LM	L-1800	6615 / 6966	42	3000 / 4000	>80
X-LINE LED 5200 LM	L-2400	5396 / 5680	34	3000 / 4000	>80
X-LINE LED 8800 LM	L-2400	8820 / 9288	56	3000 / 4000	>80

Standard colors: ☒ anodised aluminium ☒ RAL 9005 (black) ☐ RAL 9016 (white)

Dimensions:

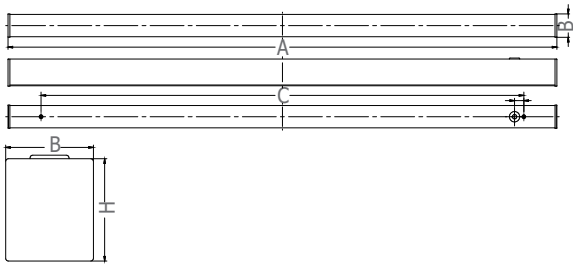

TYPE	A (mm)	B (mm)	C (mm)	H (mm)
1300 LM / L-600	572	63	440	74
2200 LM / L-600	572	63	440	74
2600 LM / L-1200	1132	63	1000	74
4400 LM / L-1200	1132	63	1000	74
3250 LM / L-1500	1412	63	1200	74
5500 LM / L-1500	1412	63	1200	74
3900 LM / L-1800	1692	63	1500	74
6600 LM / L-1800	1692	63	1500	74
5200 LM / L-2400	2252	63	2000	74
8800 LM / L-2400	2252	63	2000	74

Accessories:



slings



X-LINE SQ N LED



- Interesting, decorative and original effect
 - Simple architectural form allowing flexible arrangements and applications
 - The luminaire is the unity and without the connectors
 - Diffuser is one surface evenly illuminated
 - Housing of the luminaire made of the aluminium profile
 - Surface mounting or on slings
 - Available accessories: slings
-
- Lifetime of LED sources: 60000 h L80/B10
 - SDCM = 3
 - Operating temperature range: 5 ÷ 30° C
 - Type of optics: PLX (opalised diffuser PMMA), Micro-PRM (micro prismatic diffuser PMMA)
 - Power supply: electronic (standard) or DIM/DALI (optional)

Name	LED flux [lm]	Luminaire power [W]	Color of light [K]	CRI
X-LINE SQ N LED 5200 LM	5396 / 5680	34	3000 / 4000	>80
X-LINE SQ N LED 8800 LM	8820 / 9288	56	3000 / 4000	>80

Standard colors: ☒ anodised aluminium ☒ RAL 9005 (black) ☐ RAL 9016 (white)

Dimensions:

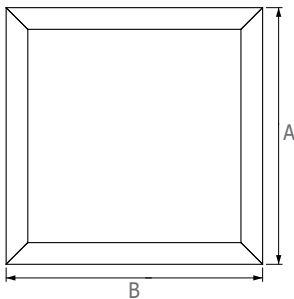

TYPE	A (mm)	B (mm)	H (mm)	H1 (mm)
5200 LM	642	642	72	max.1500
8800 LM	642	642	72	max.1500

Accessories:



slings



RUBIN LOOK LED SMOOTH COMPACT



- The housing made of steel sheet
- Surface mounting
- LED light sources ensure an even diffuser illumination, without visible shades or bright point

- Lifetime of LED sources: 50000 h L70/B10
- SDCM = 3
- Operating temperature range: 5 ÷ 30° C
- Type of optics: PLX (opalised diffuser PMMA), Micro-PRM (micro prismatic diffuser PMMA)
- Power supply: electronic (standard) or DIM/DALI (optional)

Name	LED flux [lm]	Luminaire power [W]	Color of light [K]	CRI
RUBIN LOOK LED SMOOTH COMPACT 2500 LM	2380	12	4000	>80
RUBIN LOOK LED SMOOTH COMPACT 3000 LM	3090	18	4000	>80
RUBIN LOOK LED SMOOTH COMPACT 4000 LM	4200	25	4000	>80

Standard colors: ☐ RAL9016 (white) ☒ RAL9006 (gray)

Dimensions:

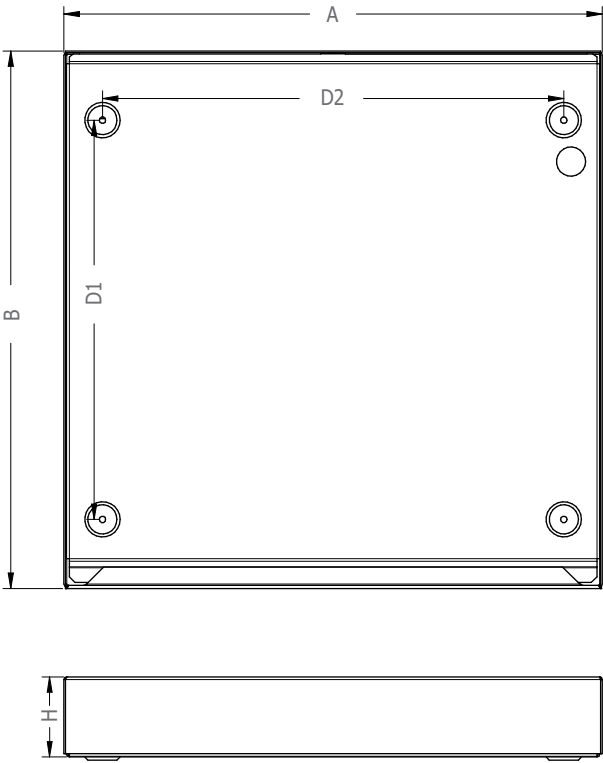

TYPE	A (mm)	B (mm)	H (mm)	D1 (mm)	D2 (mm)
RUBIN LOOK LED SMOOTH COMPACT	365	365	50	190	220



ESSENCE LED



- Minimalist and universal design fitting to almost each room
 - Small size of luminaire
 - Luminary made of aluminum
 - Equipped with highly efficient LED light sources
 - Surface mounting or on slings
 - Available accessories: slings
-
- Lifetime of LED sources: 60000 h L80/B10
 - SDCM = 3
 - Operating temperature range: 5 ÷ 30° C
 - Type of optics: PLX (opalised diffuser PMMA)
 - Power supply: electronic (standard) or DIM/DALI (optional)

Name	Lenght	LED flux [lm]	Luminaire power [W]	Color of light [K]	CRI
ESSENCE LED 3300 LM	L-900	3309 / 3483	21	3000 / 4000	>80
ESSENCE LED 2600 LM	L-1200	2698 / 2840	17	3000 / 4000	>80
ESSENCE LED 4400 LM	L-1200	4410 / 4644	28	3000 / 4000	>80
ESSENCE LED 5500 LM	L-1500	5515 / 5805	35	3000 / 4000	>80
ESSENCE LED 3900 LM	L-1800	4047 / 4260	26	3000 / 4000	>80
ESSENCE LED 6600 LM	L-1800	6615 / 6966	42	3000 / 4000	>80

Standard colors: ☒ RAL 9006 (gray) ☒ RAL 9005 (black) ☐ RAL 9016 (white)

Dimensions:

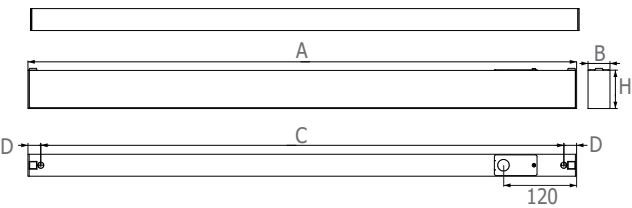

TYPE	A (mm)	B (mm)	H (mm)	C (mm)	D (mm)
3300 LM	900	36	63	858	21
2600 LM	1180	36	63	1138	21
4400 LM	1180	36	63	1138	21
5500 LM	1460	36	63	1418	21
3900 LM	1740	36	63	1698	21
6600 LM	1740	36	63	1698	21

Accessories:



RING LED



- Architectural indoor arrangement
- Effect of lighting ring
- The luminaire available surface mounting version or recessed
- The diffuser creates evenly lighting surface
- The housing made of steel sheet

- Lifetime of LED sources: 50000 h
- Operating temperature range: 5 ÷ 30° C
- Type of optics: PLX (opalised diffuser PMMA)
- Power supply: electronic (standard) or DIM/DALI (optional)

Name	LED flux [lm]	Luminaire power [W]	Color of light [K]	CRI
RING LED 5800 LM	5800	50	3000	>80
RING LED 5800 LM	5800	50	4000	>80

Standard colors: ☐ RAL 9016 (white) ☐ RAL 9010 (beige)

Dimensions:

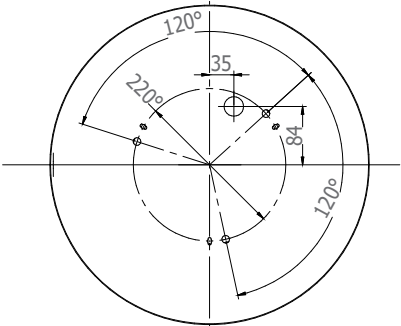
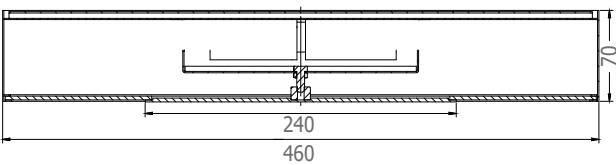

RING N LED
(surface mouted version)
IP40

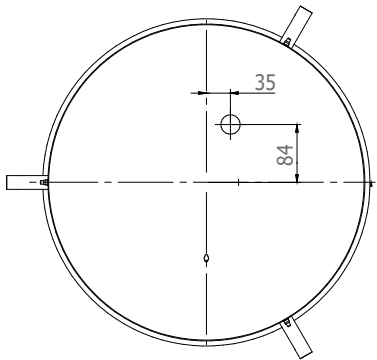
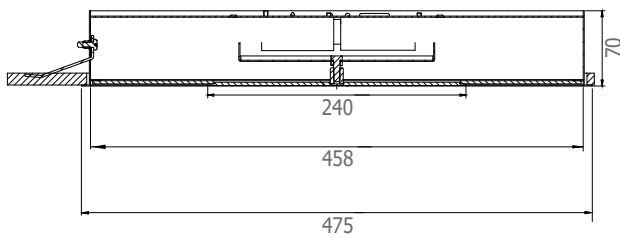

RING T LED
(recessed version)
IP43



BERYL NEW LED O



- Downlight luminaire
 - Light construction not weighting down the ceiling
 - The housing made of aluminium sheet
 - Product available in three dimensions
 - Mounting on suspended plasterboard ceilings or on modular ceilings
-
- Lifetime of LED sources: 1800/2800/5400 LM - 83000 h (L90/B10); 3600 LM - 84000 h (L90/B10)
 - SDCM = 2
 - Operating temperature range: 5 ÷ 30° C
 - Type of diffuser: PLX (opalised diffuser PMMA), Micro-PRM (micro prismatic diffuser PMMA) or SH (hardened glass)
 - Power supply: electronic (standard) or DIM/DALI (optional)

Name	Type	LED flux [lm]	Luminaire power [W]	Color of light [K]	CRI
BERYL NEW LED O 1800 LM	O-1	1760 / 1820	15	3000 / 4000	85
BERYL NEW LED O 2800 LM	O-2	2630 / 2805	20	3000 / 4000	85
BERYL NEW LED O 3600 LM	O-2	3660 / 3875	28	3000 / 4000	80
BERYL NEW LED O 5400 LM	O-3	5530 / 5720	42	3000 / 4000	85

Standard color: ☐ RAL 9016 (white)

Dimensions:

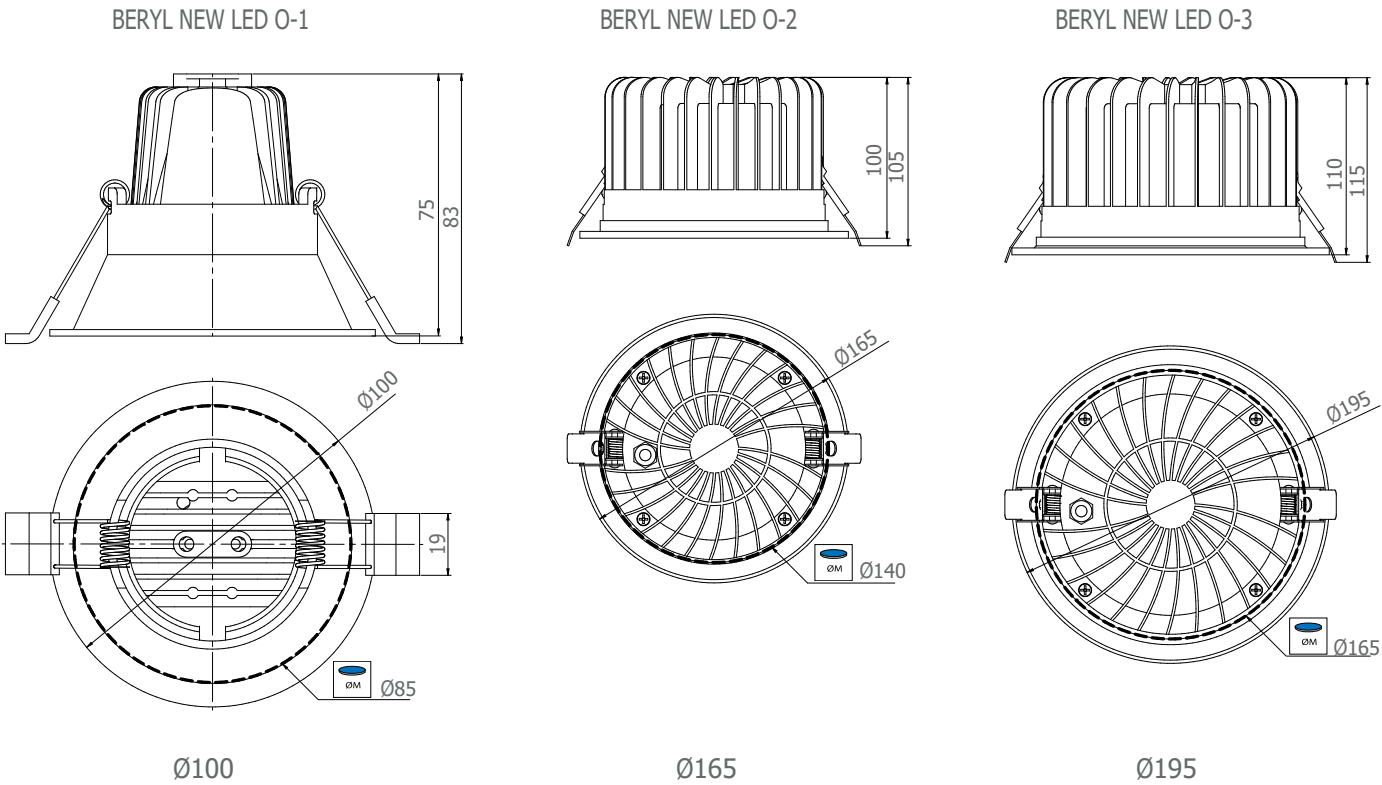

BERYL N NEW LED O



- Downlight luminaire
 - Energy saving product
 - Product available in three dimensions
 - Ceiling mounted
-
- Lifetime of LED sources: 1800/2800/5400 LM - 83000 h (L90/B10); 3600 LM - 84000 h (L90/B10)
 - SDCM = 2
 - Operating temperature range: 5 ÷ 30° C
 - Type of diffuser: PLX (opalised diffuser PMMA), Micro-PRM (micro prismatic diffuser PMMA) or SH (hardened glass)
 - Power supply: electronic (standard) or DIM/DALI (optional)

Name	Type	LED flux [lm]	Luminaire power [W]	Color of light [K]	CRI
BERYL N NEW LED O 1800 LM	O-1	1760 / 1820	15	3000 / 4000	85
BERYL N NEW LED O 2800 LM	O-2	2630 / 2805	20	3000 / 4000	85
BERYL N NEW LED O 3600 LM	O-2	3660 / 3875	28	3000 / 4000	80
BERYL N NEW LED O 5400 LM	O-3	5530 / 5720	42	3000 / 4000	85

Standard color: ☐ RAL 9016 (white)

Dimensions (for IP20)*:

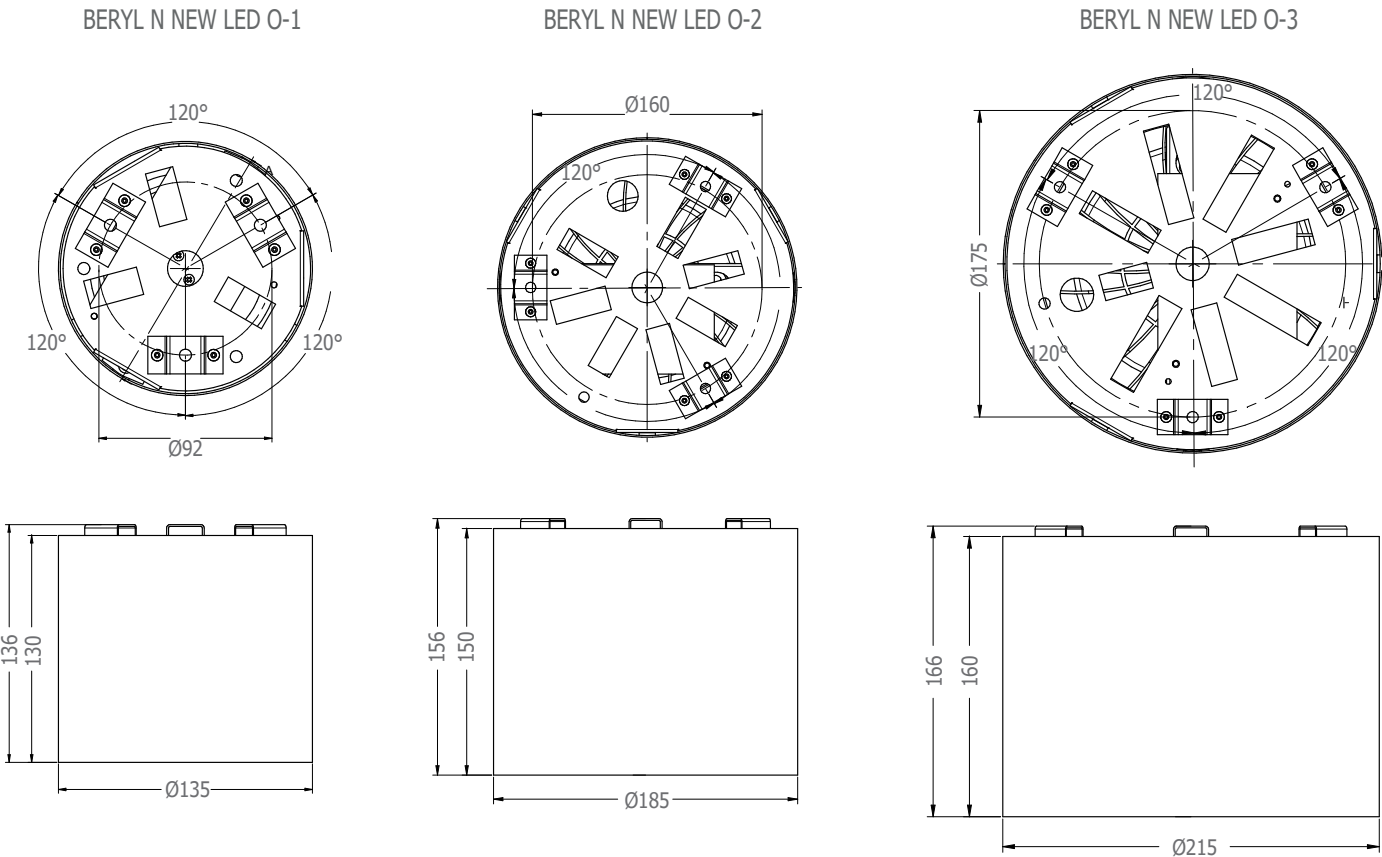

* The dimensions of the IP44 luminaire are different than the IP20 version. Detailed technical drawings we recommend to check in the catalogue cards on our website www.luxiona.pl/en



LOTOS ELEGANCE PC LED COMPACT



- Fancy form in the shape of a square or a circle
- Body and diffuser made of polycarbonate
- Surface mounting on a wall or a ceiling
- Possibility to equip with microwave movement sensor

- Lifetime of LED sources: 36000 h L70B10
- Type of diffuser: PC (opal polycarbonate diffuser)
- Power supply: electronic (standard)

Name	LED flux [lm]	Luminaire power [W]	Color of light [K]	CRI
LOTOS ELEGANCE SQUARE PC LED COMPACT 1200 LM	1200	12	4000	>80
LOTOS ELEGANCE SQUARE PC LED COMPACT 1800 LM	1800	18	4000	>80
LOTOS ELEGANCE SQUARE PC LED COMPACT 2400 LM	2400	24	4000	>80

Standard color: ☐ white

Name	LED flux [lm]	Luminaire power [W]	Color of light [K]	CRI
LOTOS ELEGANCE ROUND PC LED COMPACT 1200 LM	1200	12	4000	>80
LOTOS ELEGANCE ROUND PC LED COMPACT 1800 LM	1800	18	4000	>80

Standard color: ☐ white

Dimensions:

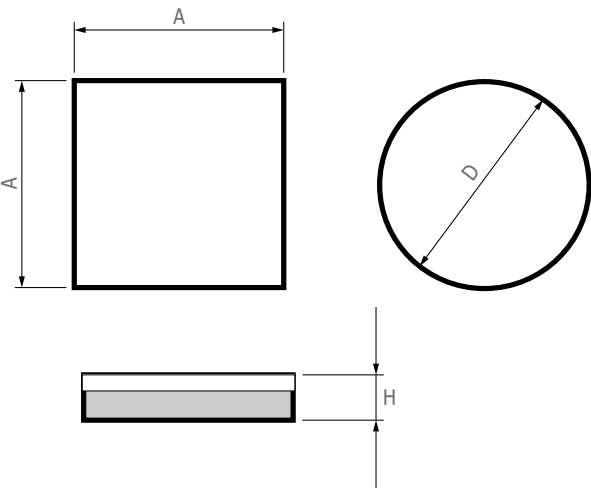

LOTOS ELEGANCE SQUARE PC LED COMPACT:

TYPE	A (mm)	H (mm)
1200 LM	220	55
1800 LM	280	55
2400 LM	280	55

LOTOS ELEGANCE ROUND PC LED COMPACT:

TYPE	D (mm)	H (mm)
1200 LM	220	55
1800 LM	280	55

Accessories:



microwave movement sensor



LOTOS WHITE PC LED COMPACT



- Simple form in the shape of oval or circle
- Body and diffuser made of polycarbonate
- Surface mounting on a wall or a ceiling
- Possibility to equip with microwave movement sensor

- Type of diffuser: PC (opal polycarbonate diffuser)
- Power supply: electronic (standard)

Name	LED flux [lm]	Luminaire power [W]	Color of light [K]	CRI
LOTOS OVAL WHITE PC LED COMPACT 800 LM	800	8	4000	>80

Standard color: ☐ white

Name	LED flux [lm]	Luminaire power [W]	Color of light [K]	CRI
LOTOS ROUND WHITE PC LED COMPACT 800 LM	800	8	4000	>80
LOTOS ROUND WHITE PC LED COMPACT 1200 LM	1200	12	4000	>80

Standard color: ☐ white

Dimensions:

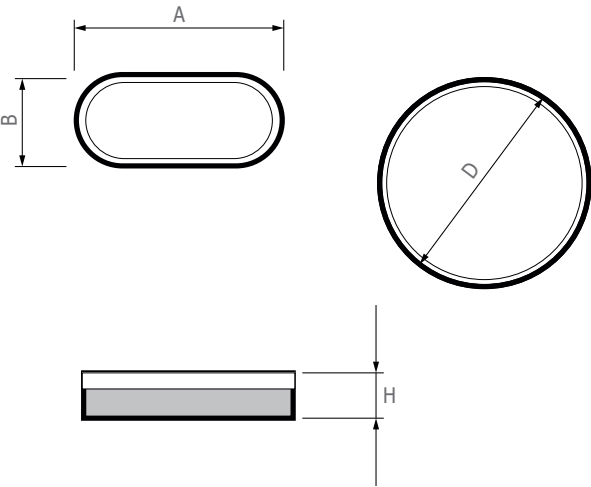

LOTOS OVAL WHITE PC LED COMPACT:

TYPE	A (mm)	B (mm)	H (mm)
800 LM	200	100	55

LOTOS ROUND WHITE PC LED COMPACT:

TYPE	D (mm)	H (mm)
800 LM	175	55
1200 LM	210	55

Accessories:



microwave movement sensor



NEPTUN LED V1

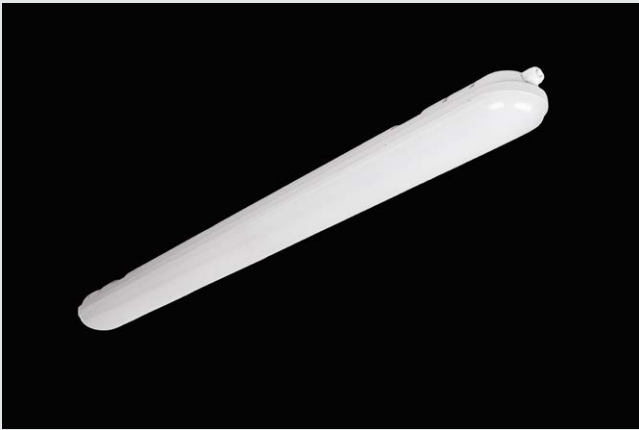

- Hermetic surface mounting luminaire
 - Equipped with highly efficient and energy saving LED modules
 - Body and shade made of polycarbonate
 - Possibility of looping through power supply
 - Recommended for underground car parks, roofed passageways
 - Three variants of power supply connection: hermetic quick release plates, led out power supply cable, without power supply cable
 - Available accessories: slings
-
- Lifetime of LED sources: 60000 h L80/B10
 - SDCM = 3
 - Operating temperature range: -25 ÷ +30° C
 - Type of optics: PC OPAL (PC opalised diffuser), PC-T (clear PC diffuser) with lenticular optical system
 - Power supply: electronic (standard) or DIM DALI (optional)

Name	LED flux [lm]	Luminaire power [W]	Color of light [K]	CRI
NEPTUN LED V1 2600 LM	2698 / 2840	17	3000 / 4000	>80
NEPTUN LED V1 4000 LM	4000 / 4000	31	3000 / 4000	>80
NEPTUN LED V1 4400 LM	4410 / 4644	28	3000 / 4000	>80
NEPTUN LED V1 5200 LM	5396 / 5680	34	3000 / 4000	>80
NEPTUN LED V1 5500 LM	5515 / 5805	35	3000 / 4000	>80
NEPTUN LED V1 8000 LM	8000 / 8000	53	3000 / 4000	>80
NEPTUN LED V1 8800 LM	8820 / 9288	56	3000 / 4000	>80
NEPTUN LED V1 10000 LM	10000 / 10000	65	3000 / 4000	>80
NEPTUN LED V1 11000 LM	11392 / 12000	77	3000 / 4000	>80

Standard color:  (gray)

Dimensions:

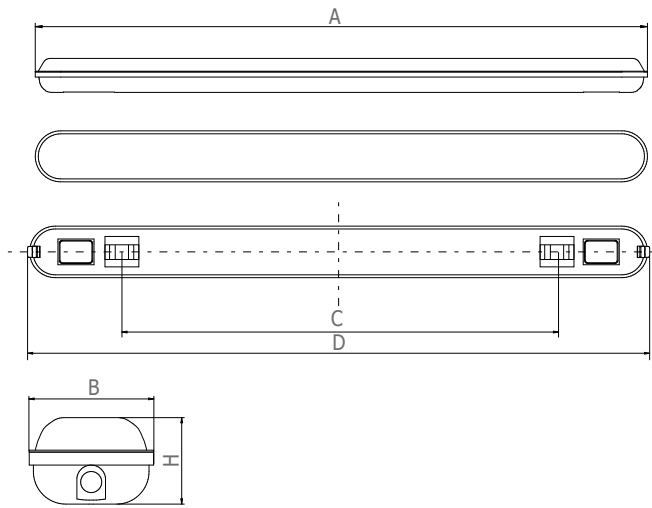

Φ [mm]	A (mm)	B (mm)	C (mm)	D (mm)	H (mm)
2600 LM	1200	100	820	1208	68
4000 LM	1200	100	820	1208	68
4400 LM	1200	100	820	1208	68
5200 LM	1200	100	820	1208	68
8000 LM	1200	100	820	1208	68
8800 LM	1200	100	820	1208	68
10000 LM	1200	100	820	1208	68
5500 LM	1500	100	1120	1508	68
11000 LM	1500	100	1120	1508	68

Luminaire available also in verion Optics:



Accessories:

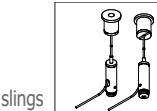



OUTDOOR LUMINAIRES

FASAD ODL LED



- The luminaire dedicated to be installed in the ground
 - The body of the luminaire made of corrosion resistant aluminium
 - The ring of the luminaire made of the INOX stainless steel
 - Intended for architectural objects and nature illumination
 - Resistance to static loads up to 2000 kg
-
- Lifetime of LED modules: 68000 h L90/B10 for 2000 lm
76000 h L90/B10 for 3000 lm
50000 h for Fasad ODL Micro LED
 - SDCM = 2
 - Operating temperature range: -25 ÷ 30° C
 - Type of diffuser: SH (hardened glass)
 - Power supply: electronic (standard)

Name	LED flux [lm]	Luminaire power [W]	Color of light [K]	CRI
FASAD ODL04 LED 2000 LM	2335 / 2430	23	3000 / 4000	85
FASAD ODL04 LED 3000 LM	3375 / 3505	28	3000 / 4000	85

Standard color: ☐ aluminum

Name	LED flux [lm]	Luminaire power [W]	Color of light [K]	CRI
FASAD ODL05 LED 2000 LM	2335 / 2430	23	3000 / 4000	85
FASAD ODL05 LED 3000 LM	3375 / 3505	28	3000 / 4000	85

Standard color: ☐ aluminum

Name	LED flux [lm]	Luminaire power [W]	Color of light [K]	CRI
FASAD ODL MICRO LED	170	3	3000	>80

Standard color: ☐ aluminum

Dimensions:

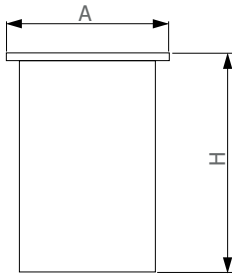

TYPE	A (mm)	H (mm)
ODL04	220	300
ODL05	270	360



FASAD ODL04 LED



FASAD ODL05 LED

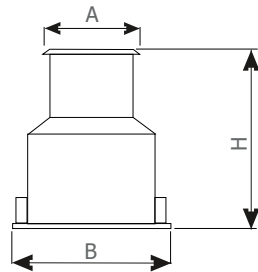

TYPE	A (mm)	B (mm)	H (mm)
ODL MICRO	56	100	100



FASAD ODL MICRO LED



KUBIK WALL ECO LED



- The luminaire intended for a balcony
- The body of the luminaire made of corrosion resistant aluminium
- Intended for LED light sources for popular G9 socket
- Light distribution upward and downward; only upward or only downward
- Two size versions for single or double light sources
- Spotlighting or decorative illumination of the building facade

- LED flux, power, color of light, lifetime: depending on applied light source
- Type of diffuser: PLX (opalised diffuser PMMA)
- Power supply: not required

Name	Number of sources	Type of LED source [W]	Socket	Power / LED Flux / Color of light / CRI
KUBIK WALL ECO LED UP & DOWN	1 x LED	Retrofit	G9	* - depending on applied light source
KUBIK WALL ECO LED UP OR DOWN	1 x LED	Retrofit	G9	* - depending on applied light source
KUBIK WALL ECO LED UP & DOWN	2 x LED	Retrofit	G9	* - depending on applied light source
KUBIK WALL ECO LED UP OR DOWN	2 x LED	Retrofit	G9	* - depending on applied light source

Standard colors: ☒ RAL7016 (anthracite) ☐ RAL9016 (white) ☒ RAL9005 (black)

Dimensions:

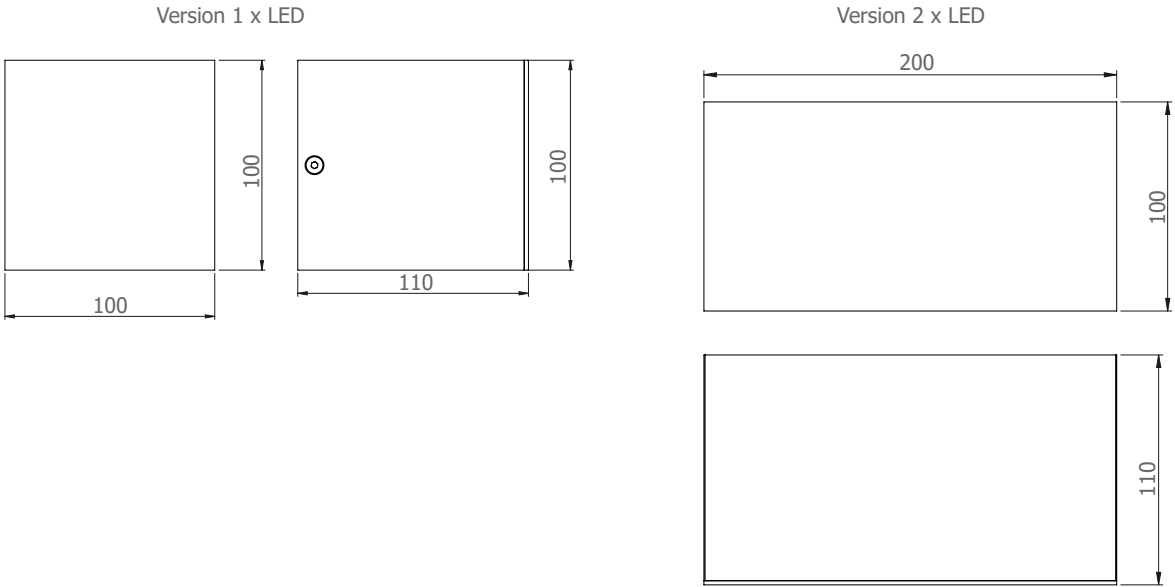

ONLINE N LED



- The luminaire intended for a balcony
 - The body of the luminaire made of corrosion resistant aluminium
 - Intended for LED light sources for popular E27 socket
 - Simple replacement of the light source
 - Surface mounting on the ceiling
 - Also available version: lamp bracket
-
- LED flux, power, color of light, lifetime: depending on applied light source
 - Type of diffuser: PLX (opalised diffuser PMMA)
 - Power supply: not required

Name	Number of sources	Type of LED source [W]	Socket	Power / LED Flux / Color of light / CRI
ONLINE N 1x max 23W	1 x max 23W	LED	E27	* - depending on applied light source

Standard colors: RAL9006 (gray) RAL9007 (dark gray)

Dimensions:

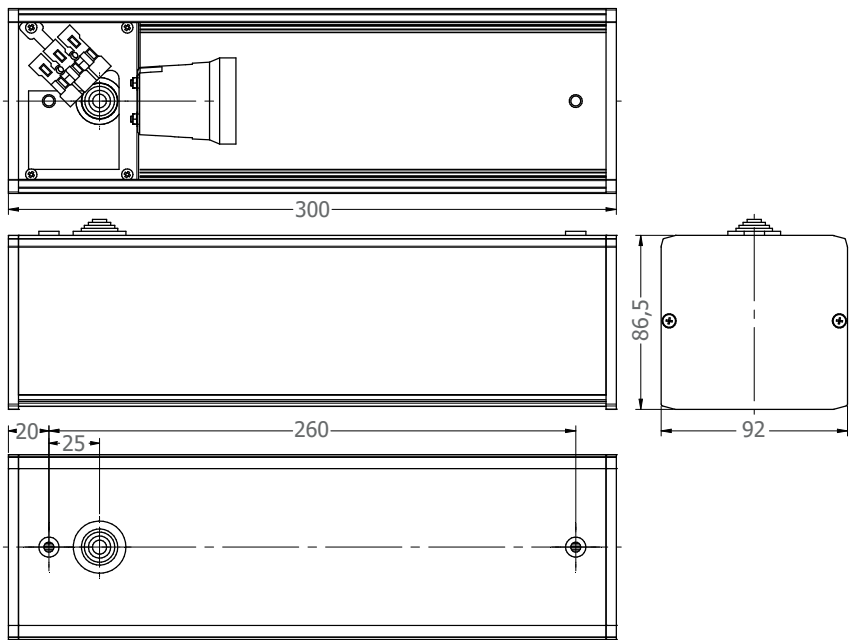

MARK LED



- Compact post for emphasizing illumination of paths and courtyards
- The housing made of embossed aluminium
- Available two types of light distribution: unilateral or bilateral
- Mounting directly to the surface or the ground

- Lifetime of LED sources: 50000 h
- SDCM = 3
- Operating temperature range: -20 ÷ +35° C
- Power supply: electronic (standard)



Name	LED flux [lm]	Luminaire power [W]	Color of light [K]	CRI
MARK LED (unilateral)	254	7	3000 / 4000	>80
MARK LED (bilateral)	265	6	3000 / 4000	>80

Standard color:  anthracite

Dimensions:

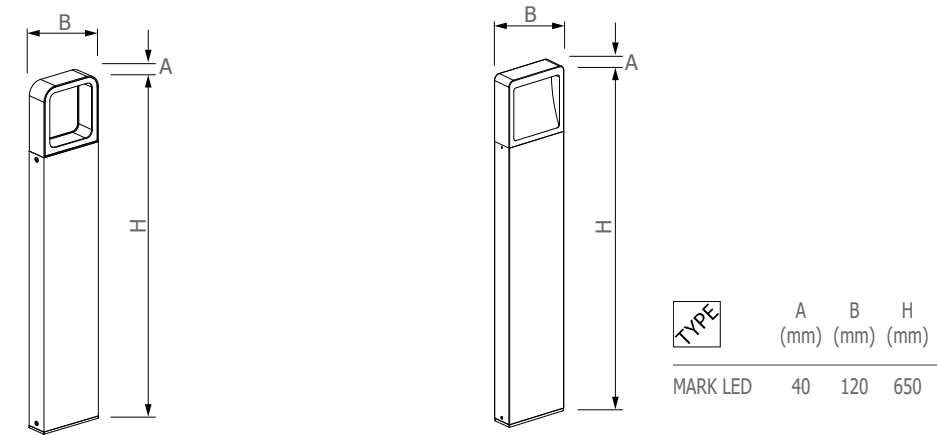

POLAR LED

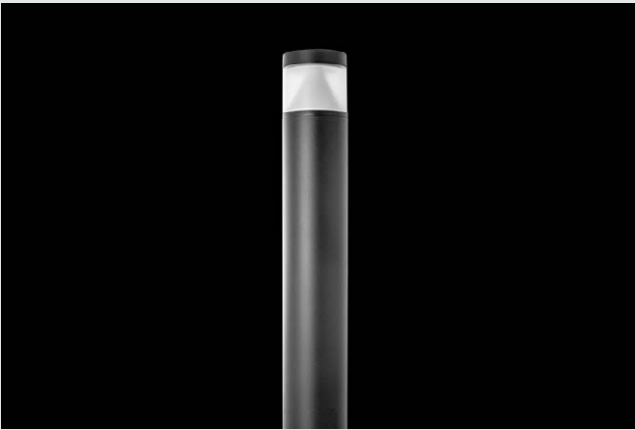

- Cylindrical post for emphasizing illumination of paths or courtyards
- The housing made of embossed aluminium
- Is equipped with an aluminium reflector of high efficiency
- Mounting directly to the surface or the ground

- Lifetime of LED sources: 35000 h
- SDCM = 3
- Operating temperature range: -20 ÷ +40° C
- Type of diffuser: opal diffuser
- Power supply: electronic (standard)

Name	LED flux [lm]	Luminaire power [W]	Color of light [K]	CRI
POLAR LED	800	8	3000 / 4000	>80

Standard color:  RAL7016 (anthracite)

Dimensions:

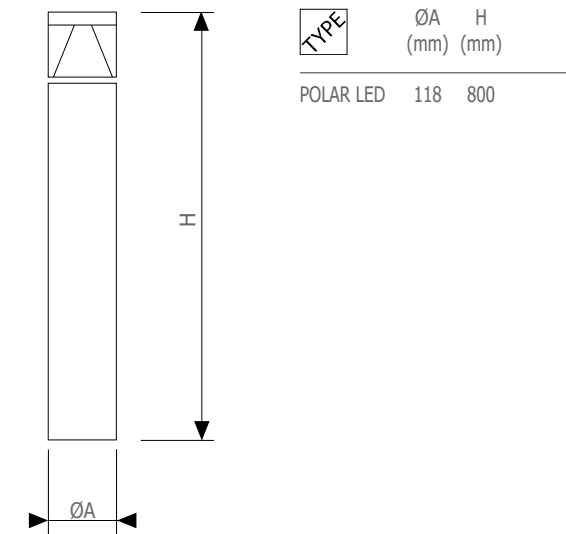

KUBIK POLE LED

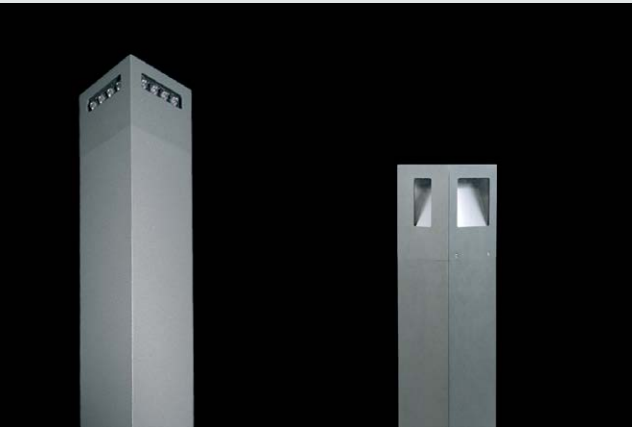

- Post for emphasizing illumination of paths and courtyards
 - Pole LED version equipped with optical system based on lenses
 - Pole ODB LED version equipped with optical system based on reflector
 - Available light colours: 3000 K / 4000 K / 6000 K when CRI>80
 - Light distribution ranges from unilateral up to four directions
 - The height of the luminaire from 300 mm to 4000 mm
 - Mounting directly to the ground by means of intended foundation
 - Accessories: dedicated foundations with reinforcement for concreting or concreted reinforcements foundations
-
- Lifetime of LED sources: 50000 h L70/B50
 - SDCM = 5
 - Operating temperature range: -25 ÷ +30° C
 - Power supply: electronic (standard)

Name	Number of lenses	Luminaire power [W]	Lenses placement	Light distribution
KUBIK POLE LED / POLE ODB LED	2 x 1,7 W	5	0/2/0/0	
KUBIK POLE LED / POLE ODB LED	3 x 1,7 W	7	0/3/0/0	
KUBIK POLE LED / POLE ODB LED	4 x 1,7 W	10	0/4/0/0	
KUBIK POLE LED / POLE ODB LED	4 x 1,7 W	10	2/0/2/0	
KUBIK POLE LED / POLE ODB LED	6 x 1,7 W	13	3/0/3/0	
KUBIK POLE LED / POLE ODB LED	8 x 1,7 W	15	4/0/4/0	
KUBIK POLE LED / POLE ODB LED	6 x 1,7 W	13	2/2/2/0	
KUBIK POLE LED / POLE ODB LED	9 x 1,7 W	19	3/3/3/0	
KUBIK POLE LED / POLE ODB LED	12 x 1,7 W	23	4/4/4/0	
KUBIK POLE LED / POLE ODB LED	4 x 1,7 W	10	1/2/1/0	
KUBIK POLE LED / POLE ODB LED	5 x 1,7 W	12	1/3/1/0	
KUBIK POLE LED / POLE ODB LED	6 x 1,7 W	13	1/4/1/0	
KUBIK POLE LED / POLE ODB LED	8 x 1,7 W	15	2/2/2/2	
KUBIK POLE LED / POLE ODB LED	12 x 1,7 W	23	3/3/3/3	
KUBIK POLE LED	16 x 1,7 W	33	4/4/4/4	

Standard color: RAL9007 (dark gray)

Detailed values of the luminous flux for particular luminaires are recommended to be checked i the catalogue cards on our website www.luxiona.pl/en

Dimesions:

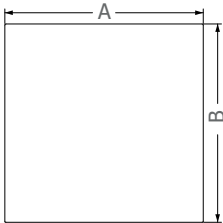
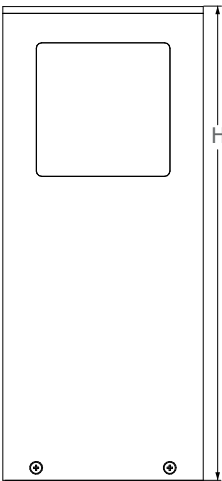

TYPE	A (mm)	B (mm)	H (mm)	TYPE	A (mm)	B (mm)	H (mm)
KUBIK POLE ODB 300	150	150	300	KUBIK POLE 300	150	150	300
KUBIK POLE ODB 600	150	150	600	KUBIK POLE 600	150	150	600
KUBIK POLE ODB 900	150	150	900	KUBIK POLE 900	150	150	900
KUBIK POLE ODB 3000	150	150	3000	KUBIK POLE 3000	150	150	3000
KUBIK POLE ODB 4000	150	150	4000	KUBIK POLE 4000	150	150	4000

Accessories:

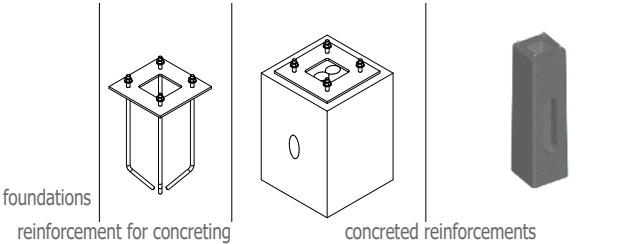

KUBIK POLE 2D LED



- Post of rectangular shape for an emphasizing illumination of paths and courtyards
- Attractive style of lighting
- The housing made of an aluminium cast
- Mounting directly to the ground by means of intended foundation
- Accessories: dedicated concreted reinforcements foundations

- Lifetime of LED sources: 100000 h (L80/B10)
- SDCM = 2
- Operating temperature range: -25 ÷ +30° C
- Power supply: electronic (standard)

Name	LED flux [lm]	Luminaire power [W]	Color of light [K]	CRI
KUBIK POLE 2D LED 1800 LM	1730 / 1800 / 1820	14	3000 / 4000 / 5000	>85

Standard color:  RAL7016 (anthracite)

Dimensions:

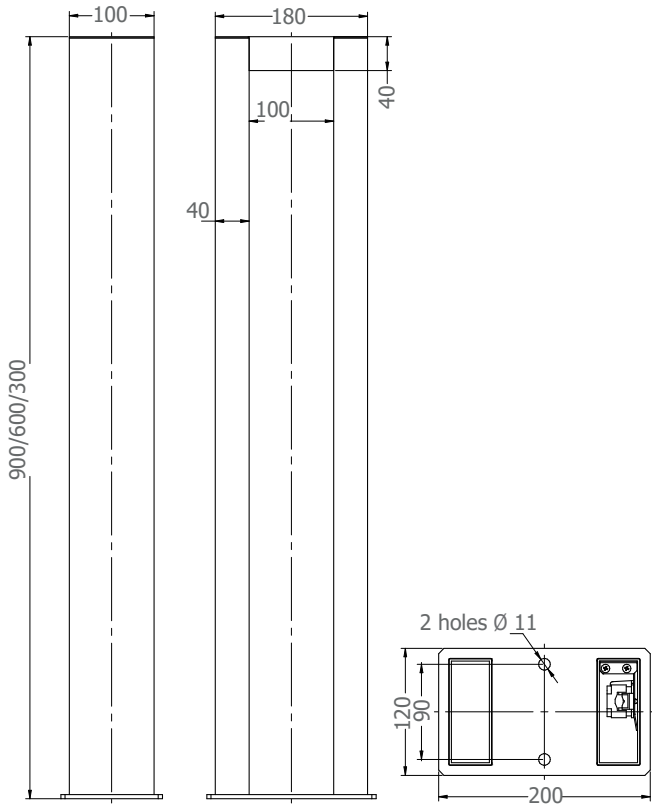

Accessories:

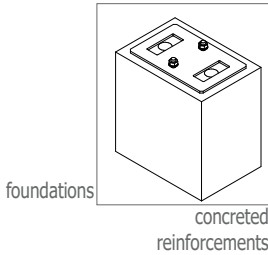

KUBIK POLE 4D LED

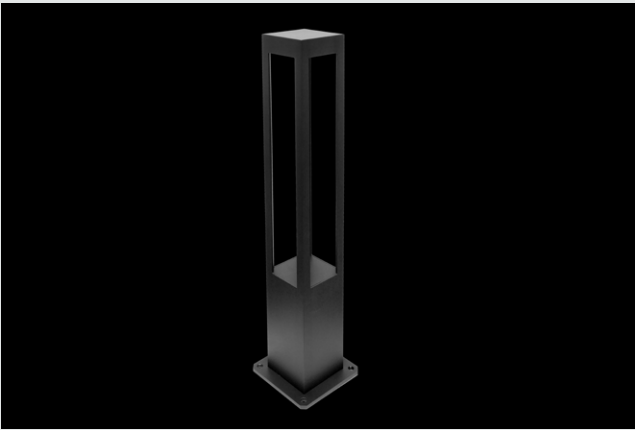

- Post of rectangular shape for an emphasizing illumination of paths and courtyards
 - Attractive style of lighting
 - The housing made of an aluminium cast
 - Mounting directly to the ground by means of intended foundation
 - Possibility of preparing various heights upon a special request
 - The colour of the light is 3000 K and 5000 K available upon a special request
 - Accessories: dedicated foundations with reinforcement for concreting or concreted reinforcements foundations
-
- Lifetime of LED sources: 60000 h (L70/B10)
 - SDCM = 5
 - Operating temperature range: -25 ÷ +30° C
 - Power supply: electronic (standard)

Name	LED flux [lm]	Luminaire power [W]	Color of light [K]	CRI
KUBIK POLE 4D LED 2000 LM	2075	18	4000	>80
KUBIK POLE 4D LED 3900 LM	3925	37	4000	>80
KUBIK POLE 4D LED 5500 LM	5540	58	4000	>80

Standard color: RAL7021 (black grey)

Dimensions:

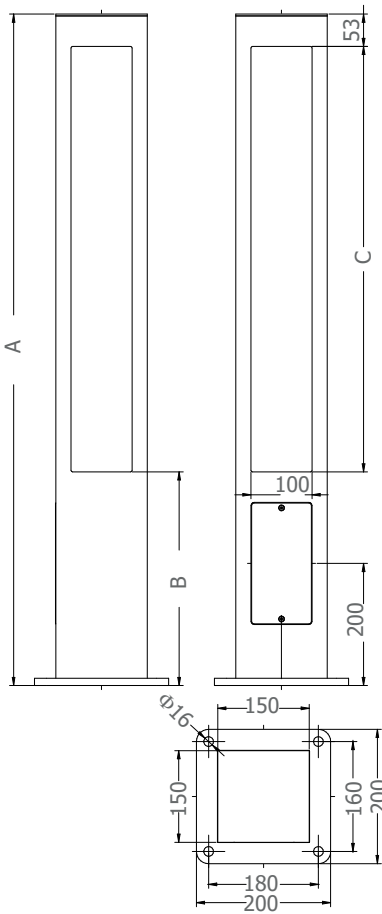

TYPE	A (mm)	B (mm)	C (mm)
2000/3900/5500 LM	1100*	350	697
* - different heights upon request			

Accessories:

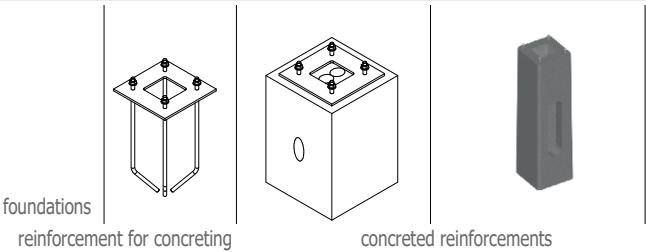

KUBIK POLE L LED / KUBIK POLE T LED



- The luminaires intended for streets, car parks and parks illumination
- The housing made of an aluminium cast
- The optacal system based on modern lenses
- Mounting directly to the ground by means of intended foundation
- Possibility of preparing various heights
- Accessories: dedicated concreted reinforcements foundations

- Lifetime of LED sources: 50000 h (L70/B10)
- SDCM = 5
- Operating temperature range: -25 ÷ +30° C
- Power supply: electronic (standard)

Name	LED flux [lm]	Luminaire power [W]	Color of light [K]	CRI
KUBIK POLE L LED 5000 LM	4966	37	5700	>70
KUBIK POLE L LED 7500 LM	7450	56	5700	>70
KUBIK POLE L LED 10000 LM	9933	75	5700	>70
KUBIK POLE L LED 15000 LM	14900	112	5700	>70

Standard color: RAL9005 (black)

Name	LED flux [lm]	Luminaire power [W]	Color of light [K]	CRI
KUBIK POLE T LED 10000 LM	9933	75	5700	>70
KUBIK POLE T LED 15000 LM	14900	112	5700	>70
KUBIK POLE T LED 20000 LM	19866	150	5700	>70
KUBIK POLE T LED 30000 LM	29800	225	5700	>70

Standard color: RAL9005 (black)

Dimensions:

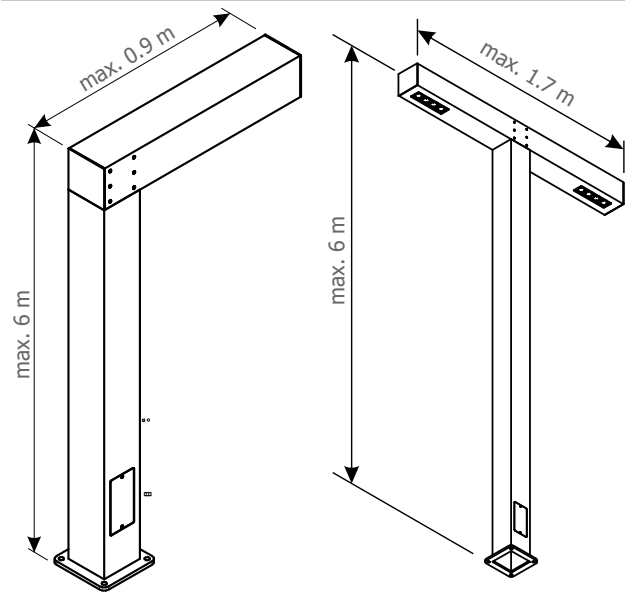

*detailed dimensions are recommended to be checked in the catalogue or on our website www.luxiona.pl/en

Note:
Luminaires up to 6 m high can be safely used in the first and third wind zones (according to PN-EN 1991-1-4) and in the third and fourth terrain categories (according to PN-EN 40-3-1:2004). II wind zone and other terrain categories require an individual assessment of the maximum binding height.

Accessories:



foundations
concreted reinforcements

www.luxiona.pl/en



FILAR LED



- An attractive outdoor lighting luminaire
 - The base made of aluminium
 - Cylindrical shade made of acrisatin
 - Perfect for emphasizing a prestigious rank of an object
 - Mounting directly to the ground by means of intended foundation
 - Available three heights: 2,5 m / 3,0 m / 4,0 m
-
- Lifetime of LED sources: 50000 h (L70/B50)
 - Operating temperature range: -25 ÷ +30° C
 - Power supply: electronic (standard)

Name	LED flux [lm]	Luminaire power [W]	Color of light [K]	CRI
FILAR LED 5000 LM L-2500	5040 / 5600 / 5600	63	3000 / 4000 / 5700	>80
FILAR LED 10000 LM L-2500	10080 / 11200 / 11200	125	3000 / 4000 / 5700	>80
FILAR LED 7500 LM L-3000	6840 / 7600 / 7600	85	3000 / 4000 / 5700	>80
FILAR LED 15000 LM L-3000	13680 / 15200 / 15200	170	3000 / 4000 / 5700	>80
FILAR LED 10000 LM L-4000	10440 / 11600 / 11600	130	3000 / 4000 / 5700	>80
FILAR LED 20000 LM L-4000	20970 / 23300 / 23300	261	3000 / 4000 / 5700	>80

Standard color: RAL9005 (black)

Dimension:

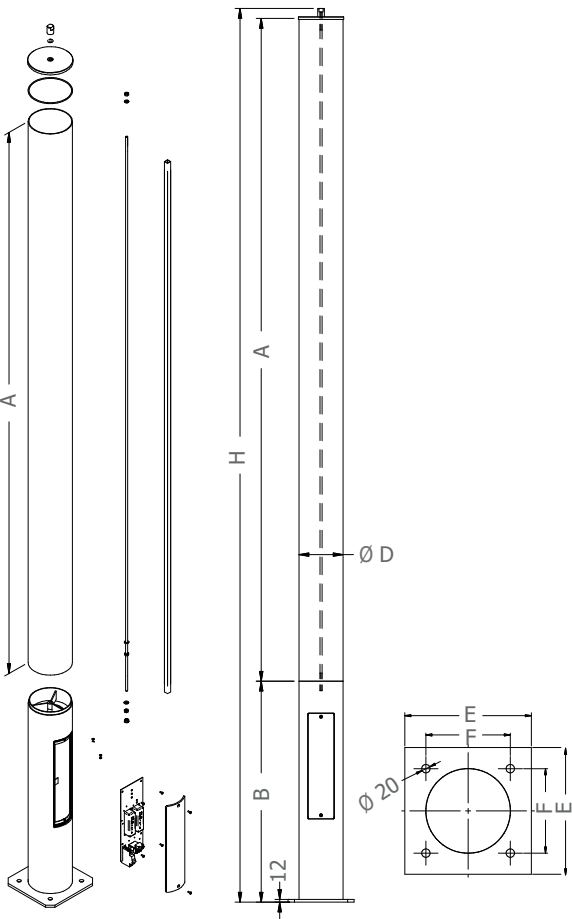

TYPE	A (mm)	B (mm)	H (mm)	D (mm)	E (mm)	F (mm)
FILAR LED L-2500	1500	1000	2545	200	300	200
FILAR LED L-3000	2000	1000	3045	200	300	200
FILAR LED L-4000	3000	1000	4045	200	300	200

Accessories:





LAMPAS LED



- Wide range of applications
 - Diversified ways of mounting
 - Adapted to generally accessible LED strips of width up to 10 mm
 - At choice different shapes and profiles lengths
 - Wide range of intended diffusers
 - Huge choice of accessories
 - Two levels of protection against dust and water penetration - IP20 and IP67
 - Possibility of creating various patterns
 - Products which provide glamorous decorative lighting
-
- Parametry LED: depending on applied LED stipe
 - Operating temperature range: -25 ÷ +25° C
 - Power supply: electronic (12 V recommended)

Name	Available lengths	Light source	Power / LED flux / Color of light / CRI *
LAMPAS GK1	1 m / 2 m / 3 m	LED stipe	* - depending on applied light source
LAMPAS N1	1 m / 2 m / 3 m	LED stipe	* - depending on applied light source
LAMPAS O	1 m / 2 m / 3 m	LED stipe	* - depending on applied light source
LAMPAS OUT	1 m / 2 m / 3 m	LED stipe	* - depending on applied light source
LAMPAS V	1 m / 2 m / 3 m	LED stipe	* - depending on applied light source

Standard color: depending on chosen profile**

Dimensions:

LAMPAS N1	LAMPAS V	LAMPAS O	LAMPAS GK1	LAMPAS OUT

Accessories:

Wide range of accessories**, which includes among other:

lenses
transparent or 'opal' diffuser
standard plugs or with an option for loop through wiring
systems of clips and suspensions
fixtures

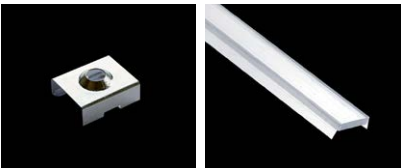

** The list of intended accessories and available colours for particular profiles we recommend to check in the catalogue cards on our website www.luxiona.pl/en

LED PROFILES

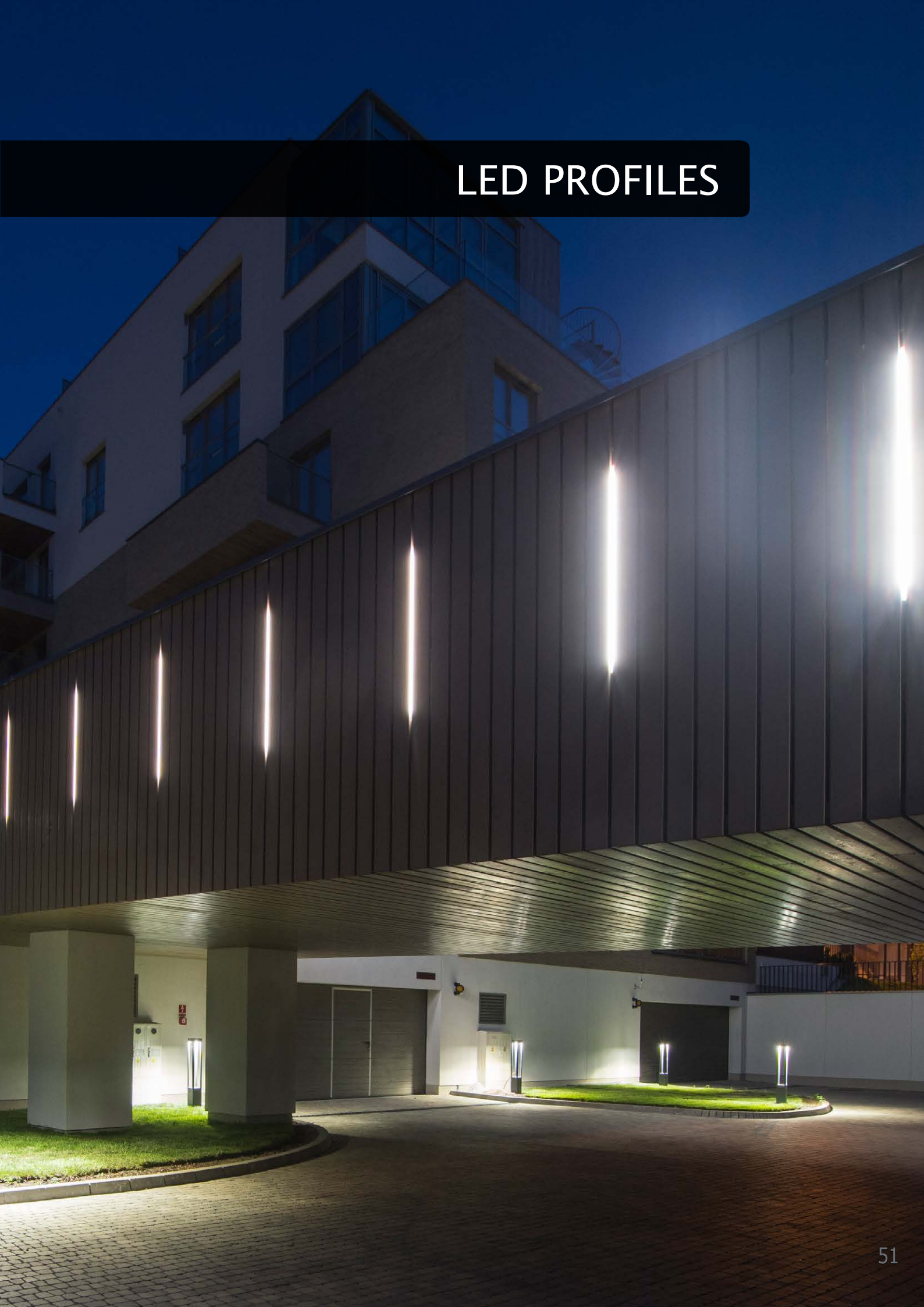

LUXIONA



OFFICE OF THE MANAGEMENT BOARD /TRADE OFFICE:

LUXIONA Poland S.A. Macierzysz near Warsaw
ul. Sochaczewska 110,
05-850 Ozarow Mazowiecki
sekretariat@luxiona.com

www.luxiona.pl/en

www.luxiona.com

EXPORT DEPARTMENT:

UK, IR
+44 (0) 757 034 2028
+48 600 987 439
export@luxiona.com

DE, AT, CH, LI
+49 30 40535600
info@luxiona.de

SE, NO, DK, IS, NL
+ 48 505 695 581
export@luxiona.com

RU, UA, LV, BY, MD, GE, AM, AZ,
KZ, UZ, TM, TJ, KG, BE, LU
+48 505 695 638
export@luxiona.com

LT, EE, FI
+ 370 650 22 522
export@luxiona.com

HR, HU, RO, XS, SI
+48 505 695 568
export@luxiona.com

CZ, SK, BA, ME, MK, XK, AL, BG
+ 48 604 442 101
export@luxiona.com

DESIGN DEPARTMENT:

+ 48 22 721 72 29
+ 48 600 460 144
projektanci@luxiona.com

LUXIONA Poland is part of the Spanish LUXIONA Group, which for more than 80 years has been successfully operating on the international market of the lighting industry. The mission of LUXIONA Poland is to create complementary lighting solutions, in accordance with the most recent technologies as well as legal and social requirements. For that reason, an active team constantly works on innovative technical solutions, keeping in mind the need for saving energy and protecting the environment. The team does not cease to enhance the quality of our products and the efficiency of our services, permanently analyzing the needs of our Customers.

The LUXIONA Group, including LUXIONA Poland which continues to implement the Group strategy, specializes in the composition and creation of indoor and outdoor lighting systems, basing on the vast experts' experience and the broad scope of product brands. An integral part in the offer of LUXIONA Poland are comprehensive lighting solutions, which cover both the production and design services, in the widest sense of the word, delivered by high class designers and ready to meet the requirements of, among others: architectural spaces, areas in the so-called clean rooms, commercial surfaces etc. The LUXIONA Poland team specializes in implementing projects which require an individual approach and the application of modern technologies.